

ABERNATHY and ASSOCIATES

Kenneth B. Abernathy Jr.

Wisconsin Registered Land Surveyor S-1594

Rt. 3, Box 273
Elkhorn, Wisconsin 53121
Phone: (414) 723-4260 (office)
(414) 723-4813 (residence)

PLAT OF SURVEY

LEGAL DESCRIPTION

Lot 38 of Evergreen Estates Subdivision located in the Southwest 1/4 of the Northwest 1/4 and the Southwest 1/4 of the Southwest 1/4 and the Northwest 1/4 of the Southwest 1/4 and the Northeast 1/4 of the Southwest 1/4 and the Southeast 1/4 of the Southwest 1/4 of Section 18, and the Southwest 1/4 of the Northwest 1/4 and the Northwest 1/4 of the Northwest 1/4 and the Northeast 1/4 of the Northwest 1/4 and the Southeast 1/4 of the Northwest 1/4 and the Northwest 1/4 of the Northeast 1/4 of Section 19, Town 3 North, Range 17 East, Town of La Fayette, County of Walworth, State of Wisconsin.

Ordered by: Dan Finke Construction
5870 Highway 36
Burlington, Wisconsin 53105

Owner: Jeff Lawrence
24 1/2 East Walworth Street
Elkhorn, Wisconsin 53121



Legend

- FOUND IRON PIPE
- FOUND IRON ROD
- FOUND BRASS CAPPED MONUMENT
- FOUND CONCRETE MONUMENT
- CHISEL CUT IN CONCRETE
- SET IRON ROD, 24" LONG, WEIGHING 1.5 LBS./LINEAL FT., 3/4" DIA.
- SET IRON ROD, 36" LONG, WEIGHING 4.5 LBS./LINEAL FT., 1-1/16" DIA.
- RECORDED AS DIMENSION
- EXISTING FENCE

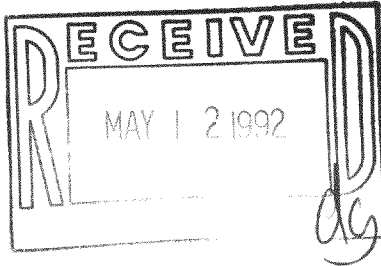

SCALE: 1" = 20 FEET

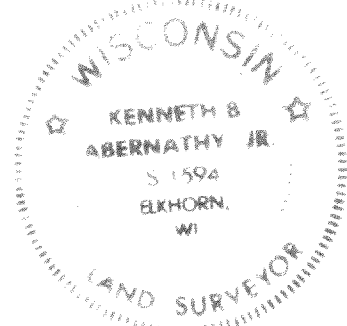

I hereby certify that I have surveyed the above described property and that the above map is a true representation thereof and shows the size and location of the property, its exterior boundaries, the location of all visible structures and dimensions of all principal buildings thereon, boundary fences, apparent easements, roadways and visible encroachments, if any.
This survey is made for the use of the present owners of the property, and also those who purchase, mortgage, or guarantee the title thereto within one year from date hereof.

Kenneth B. Abernathy Jr.
KENNETH B. ABERNATHY, JR.
WISCONSIN REGISTERED LAND SURVEYOR,
S-1594
Date: April 23, 1992 Job No. 1991.402

PLAT OF SURVEY

LEGAL DESCRIPTION

Lot 38 of Evergreen Estates Subdivision, located in the Southwest 1/4 of the Northwest 1/4 and the Southwest 1/4 of the Southwest 1/4 and the Northwest 1/4 of the Southwest 1/4 and the Northeast 1/4 of the Southwest 1/4 and the Southeast 1/4 of the Southwest 1/4 of Section 18, and the Southwest 1/4 of the Northwest 1/4 and the Northwest 1/4 of the Northwest 1/4 and the Northeast 1/4 of the Northwest 1/4 and the Southeast 1/4 of the Northwest 1/4 and the Northwest 1/4 of the Northeast 1/4 of Section 19, Town 3 North, Range 17 East, Town of La Fayette, County of Walworth, State of Wisconsin.

Ordered by: Dan Finke Construction
5870 Highway "96"
Burlington, Wisconsin 53105

Owner: Jeff Lawrence
24 1/2 East Walworth Street
Elkhorn, Wisconsin 53121

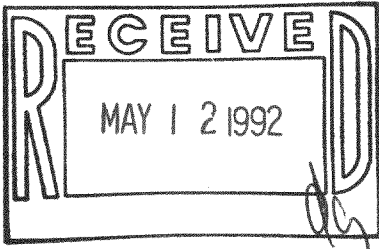

- Legend**
- FOUND IRON PIPE
 - FOUND IRON ROD
 - FOUND BRASS CAPPED MONUMENT
 - FOUND CONCRETE MONUMENT
 - CHISEL CUT IN CONCRETE
 - SET IRON ROD, 24" LONG, WEIGHING 15 LBS./LINEAL FT., 3/4" DIA.
 - SET IRON ROD, 30" LONG, WEIGHING 4.5 LBS./LINEAL FT., 1-11/16" DIA.
 - RECORDED AS DIMENSION
 - EXISTING FENCE

SCALE: 1"= 20 FEET

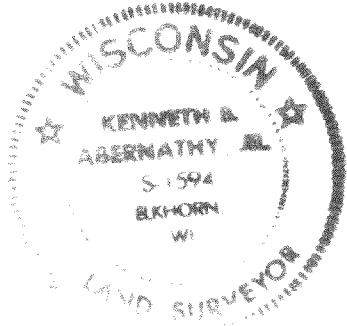

"I hereby certify that I have surveyed the above described property and that the above map is a true representation thereof and shows the size and location of the property, its exterior boundaries, the location of all visible structures and dimensions of all principal buildings thereon, boundary fences, apparent easements, roadways and visible encroachments, if any."

"This survey is made for the use of the present owners of the property, and also those who purchase, mortgage, or guarantee the title thereto within one year from date hereof."

Kenneth B. Abernathy, Jr.
WISCONSIN REGISTERED LAND SURVEYOR,
S-1594

Date: March 14, 1992 Job No. 1991.402